

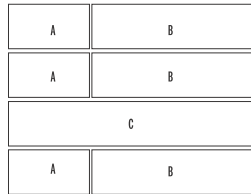

RÖCKA

DESCRIPTION: Wall & edge double-sided **TEXTURE:** Natural stone (Fossil stone)

PALLET OVERVIEW - ROW 1



PALLET OVERVIEW - ROW 2

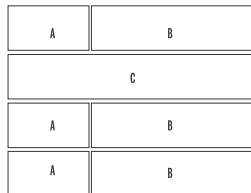

PALLET OVERVIEW - ROW 3

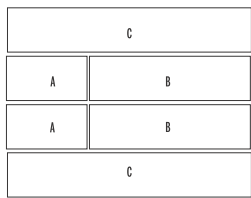

NOTES

* For an authentic look, each color option is composed of a variety of darker & lighter tones. Natural ingredients such as granite are present within the recipe to allow for a range in tones, veining and textures from one stone to another.

See page 96 to 116 for more technical information.

The dimensional tolerance for Stonedge wet cast retaining wall units is: $\pm \frac{3}{16}$ " (5 mm) for height and $\pm \frac{1}{2}$ " (13 mm) for length and width. During the installation, the level between adjacent wall units will vary (usually more than for a dry cast wall unit) in order to obtain a more realistic appearance of a natural stone wall.

Specifications per pallet	Imperial	Metric
Cubing	19.88 ft²	1.85 m ²
Approx. Weight	1 860 lbs	844 kg
Number of rows	3	
Coverage per row	6.63 ft ²	0.62 m ²
Coverage per unit	A 0.55 ft ²	0.05 m ²
	B 1.10 ft ²	0.10 m ²
	B 1.66 ft ²	0.15 m ²

Unit dimensions	in		mm		Units /pallet
	Height	Depth 1	Height	Depth 1	
A	6	7 ³ / ₄	152	197	8 units
		8		203	
		13 ¹ / ₄		337	
B	6	7 ³ / ₄	152	197	8 units
		8		203	
		26 ¹ / ₂		673	
C	6	7 ³ / ₄	152	197	4 units
		8		203	
		39 ³ / ₄		1 010	

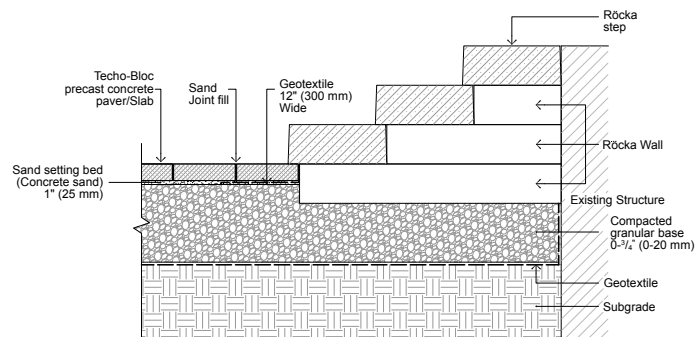

01 | Linear pattern

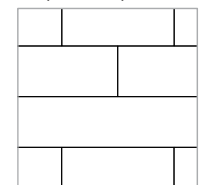

INSTALLATION GUIDE

FREESTANDING WALLS - RÖCKA

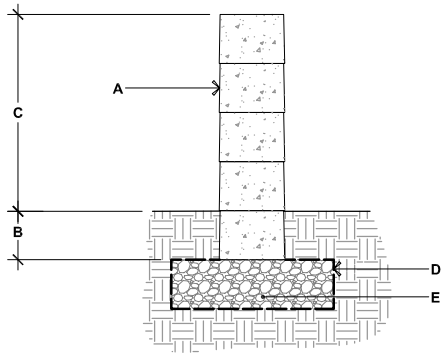

RÖCKA

- A. RÖCKA DOUBLE-SIDED WALL UNITS SECURE EACH ROW WITH CONCRETE ADHESIVE
- B. EMBEDMENT DEPTH, 6" (150 mm) MIN.
- C. 24" (612 mm) MAX.
- D. GEOTEXTILE
- E. COMPACTED GRANULAR LEVELING PAD, 6" (150 mm) THICK MIN. THICKNESS ACCORDING TO PROJECT SPECIFIC CONDITIONS

90° CORNER OF A DOUBLE-SIDED WALL

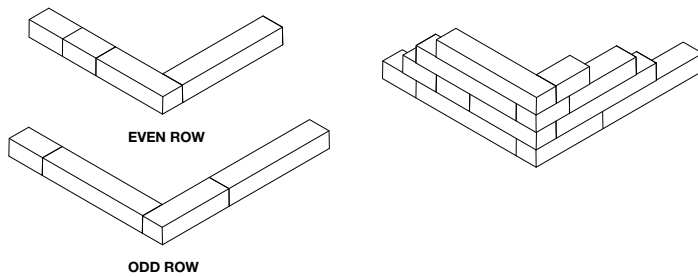

1. Alternate odd and even rows
2. Stagger vertical joints by at least $\frac{1}{4}$ of the length of the block.
3. Glue all modules at each row with a concrete adhesive.
4. It is possible to alternate the blocks (A, B or C) in the same row to create different patterns.

DOUBLE-SIDED WALL - END OF A STRAIGHT WALL

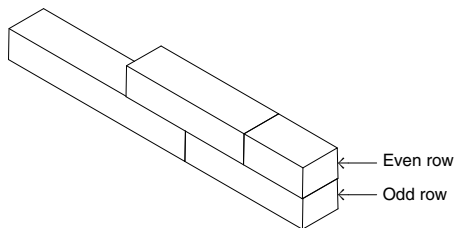

* It is possible to alternate the blocks (A, B or C) in the same row to create different patterns. However, a minimum distance of $\frac{1}{4}$ the length of the block is required between the vertical joints.